

The Copyright of this drawing/design is vested in Woodsyde Development Ltd and must not be copied or reproduced in part or whole without prior written consent

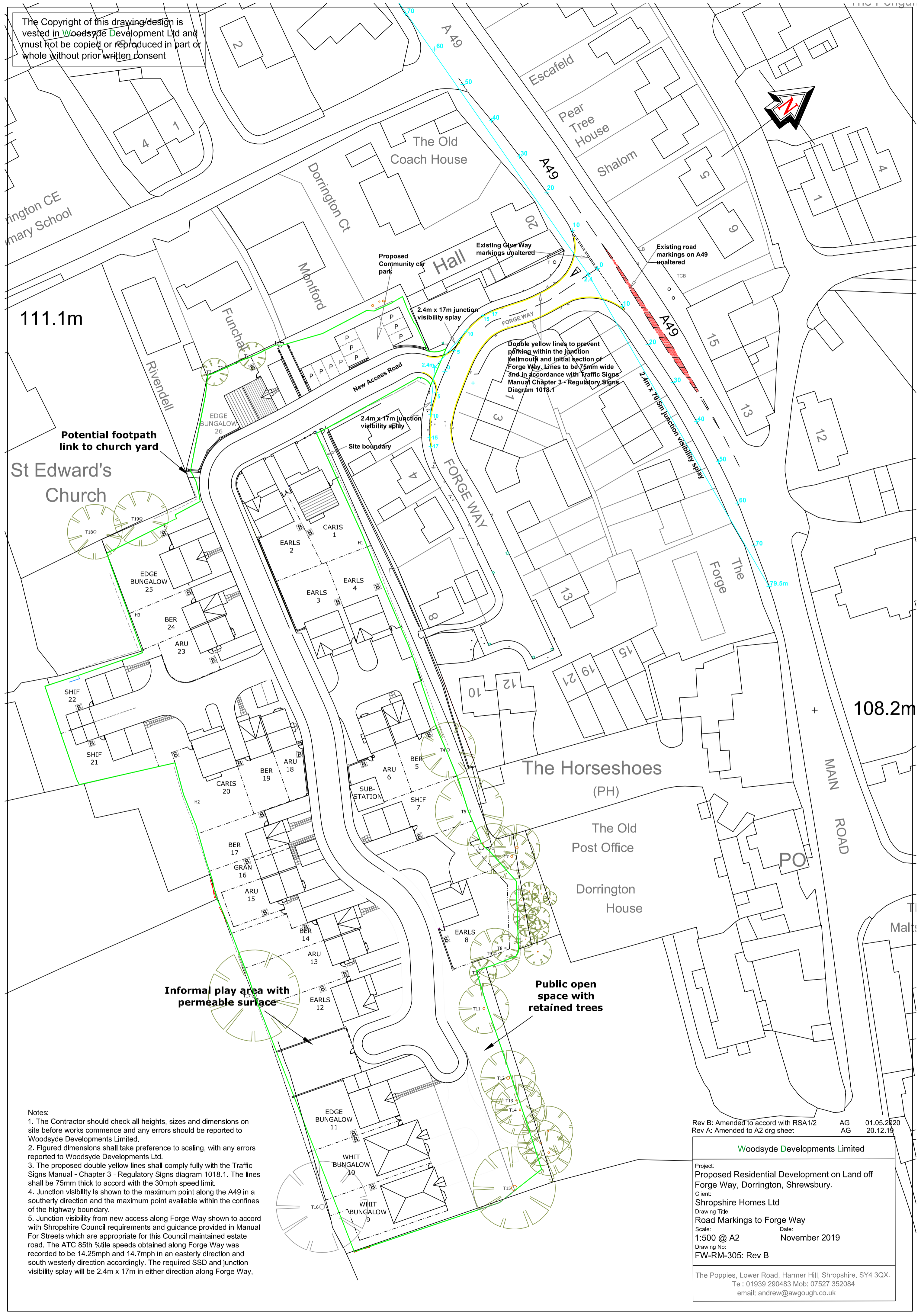

- Notes:
1. The Contractor should check all heights, sizes and dimensions on site before works commence and any errors should be reported to Woodsyde Developments Limited.
 2. Figured dimensions shall take preference to scaling, with any errors reported to Woodsyde Developments Limited.
 3. The proposed double yellow lines shall comply fully with the Traffic Signs Manual - Chapter 3 - Regulatory Signs diagram 1018.1. The lines shall be 75mm thick to accord with the 30mph speed limit.
 4. Junction visibility is shown to the maximum point along the A49 in a southerly direction and the maximum point available within the confines of the highway boundary.
 5. Junction visibility from new access along Forge Way shown to accord with Shropshire Council requirements and guidance provided in Manual For Streets which are appropriate for this Council maintained estate road. The ATC 85th %tile speeds obtained along Forge Way was recorded to be 14.25mph and 14.7mph in an easterly direction and south westerly direction accordingly. The required SSD and junction visibility splay will be 2.4m x 17m in either direction along Forge Way,

Rev B: Amended to accord with RSA1/2 AG 01.05.2020
Rev A: Amended to A2 drg sheet AG 20.12.19

Woodsyde Developments Limited	
Project: Proposed Residential Development on Land off Forge Way, Dorington, Shropshire.	
Client: Shropshire Homes Ltd	
Drawing Title: Road Markings to Forge Way	
Scale: 1:500 @ A2	Date: November 2019
Drawing No: FW-RM-305: Rev B	
The Poppies, Lower Road, Harmer Hill, Shropshire. SY4 3QX. Tel: 01939 290483 Mob: 07527 352084 email: andrew@awgough.co.uk	